

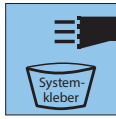

Product benefits



Climate-friendly



System Adhesive SR 6

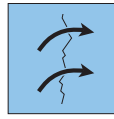

Covers cracks



Adheres directly to masonry



Breathable



Energy-saving

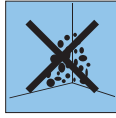

Mould-inhibiting

How to use



1. Fill cracks, chipped surfaces and seriously uneven surfaces with System Adhesive SR 6.



2. Use a Stanley knife to scarify the insulating wedge and break at the edge or cut with a saw.

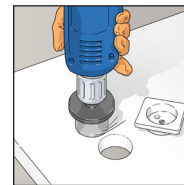

3. Use a keyhole saw to cut openings for sockets before fitting the panels.



4. Use a toothed trowel/toothed comb to comb adhesive onto the insulating wedge (min. 8 mm toothing).



5. Press the insulating wedges onto the wall beside each other with moderate pressure. Remove excess adhesive along the edges.

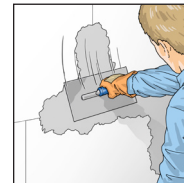

6. Fill the joints between the panels with ERFURT-KlimaTec SR 6 system adhesive.



7. Prime the insulating wedge with paste.



Product Description

ERFURT-KlimaTec DK 2

Manufacturer

ERFURT & SOHN KG • Hugo-Erfurt-Straße 1
42399 Wuppertal • GERMANY • www.erfurt.com

Raw materials/Manufacture

ERFURT KlimaTec DK 2 is an insulating wedge made of expanded glass granulate. The front side is laminated with a glass nonwoven fabric and the rear side with fabric webbing.

Product data

- Order no. 1002693
- Panel dimensions: 60 cm long x 40 cm wide ± 5 mm
2.5/0.5 cm thick
- Panels/box: 8 panels
- Weight: 1.3 kg/panel

Product features

- Thermal conductivity: $\lambda = 0.086 \text{ W/mK}$
- Fire rating „B-s1,d0“ according to EN 13501-1 corresponds to „B1“ (fire-retardant) according to DIN 4102-1
- Water vapour diffusion resistance factor: $\mu = 10$
- Energy-saving
- Mould-inhibiting
- Breathable
- Pressure-resistant
- Easy to cut
- Suitable for damp environments and dry lined walls
- Smooth surface thanks to nonwoven laminate
- Reinforced by webbed laminate on rear
- Adheres directly to masonry
- Can be directly wallpapered over with breathable wallcoverings

Application/Handling

ERFURT-KlimaTec DK 2 is an insulating wedge for the energy-saving interior insulation of walls and ceilings and where interior walls join insulated exterior walls. Using ERFURT-KlimaTec DK 2 prevents heat bridges and slows down the heat flow to the outside.

Where ERFURT-KlimaTec DK 2 is used for mould remediation, thoroughly remove any mould that has formed before applying adhesive and eliminate the cause of the mould formation. Condensation in the wall can diffuse through the insulating wedge.

Base surface

ERFURT-KlimaTec DK 2 can be used on all plasters (interior plaster as per DIN V 18550). Ensure that the base surface is dry, clean, solid and firm. Remove old wallcoverings, loose wallcoverings, vapour-tight coatings and dirt. Prime extremely absorbent, chalky and sandy base surfaces with a solvent-free primer. Fill any cracks, chipped surfaces and seriously uneven surfaces with ERFURT-KlimaTec SR 6 system adhesive.

How to use

Use a Stanley knife to scarify ERFURT-KlimaTec DK 2 insulating wedge, break along the edge and cut through fabric webbing. Alternatively use a saw to cut the insulating wedge. Use a keyhole saw to cut openings for sockets before fitting the panels.

Press ERFURT-KlimaTec DK 2 insulating wedges beside each other on the wall with moderate pressure. Remove excess adhesive along the edges. Fill the joints between the panels with ERFURT-KlimaTec SR 6 system adhesive.

Adhesion

Use ERFURT-KlimaTec SR 6 system adhesive to glue the insulating wedge. Apply the adhesive evenly directly onto the insulating wedge with a toothed trowel or toothed comb (apply a minimum 8 mm depth of adhesive). Use approx. 1.8 to 2.2 kg/m² depending on the base surface.

Base surface for wallpaper

Before wallpapering, prime the insulating wedges with a paste primer according to the manufacturer's instructions (e.g. Metylan NP Power Granulate plus in a ratio of 1:20). ERFURT-KlimaTec DK 2 insulating wedges can be wallpapered over with all breathable wallcoverings, such as woodchip, nonwoven types of wallpaper, embossed wallpaper etc. Use the adhesive recommended for the type of wallcovering, but at the very least nonwoven adhesive at a ratio of 1:10, e.g. Metylan NP New Plaster Paste, to bond to the insulating wedge.

Base surface for plaster

ERFURT-KlimaTec DK 2 insulating wedges can be coated with all mineral-based interior plasters. Apply a plaster primer before applying interior plasters.

Made in Germany

ERFURT & SOHN KG
Hugo-Erfurt-Straße 1
42399 Wuppertal

Phone.: +49 202 6110 0
Fax: +49 202 6110 89 451

E-mail: info@erfurt.com
Website: www.erfurt.com

ERFURT
WÄNDE ZUM WOHLFÜHLEN