

Product advantages

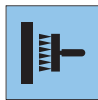

No soaking required



Wall adhesion technique

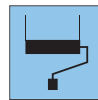

Easy to paint over

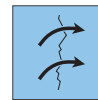

Covers over cracks



PVC-free



Highly flame-retardant



Active-breathing



Highly tear-resistant

Processing

- 1.** Cut ERFURT-FlexoMur® with additive, and roll up with underside outwards.

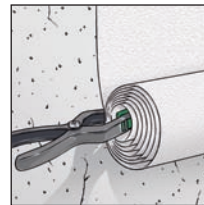
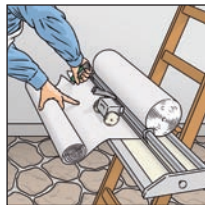

- 6.** Proceed in the same way with long lengths of fabric stuck vertically. When changing the stand position, remove superfluous adhesive. Fix width at the height of the stand position, e.g. with clamps.

- 2.** The application of the adhesive is carried out directly onto the facade surface using a colour roller in fabric width + 10 cm addition. Subsequently, remove adhesive crossways to the direction of running using the toothed spatula (size C3, B2 or G).



- 7.** Never stick around a corner. Always trim at corners.

- 3.** Lay the wall covering into the moist ERFURT-FlexoCol® with butt joint and using wall-adhesion technique. Press down using the rubber roller and/or a synthetic spatula.

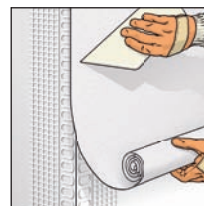

- 8.** To ensure a perfect finish, we recommend the fabric-finishing rails and corner-protection rails from the ERFURT range.

- 4.** Remove excess adhesive immediately and thoroughly. To clean up use brush, sponge, lambskin roller or similar.

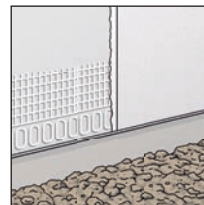
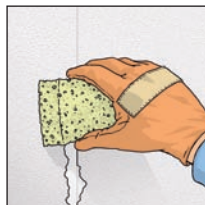

- 9.** If no finish, base or similar is provided by the customer, one can be created using the ERFURT finishing rail.

- 5.** In the event of interruptions in hanging, remove the adhesive applied over and beyond the width of fabric using the spatula. It is a good idea to work roughly 5 cm inside the seam so that it is not necessary to apply adhesive exactly to the edge of the fabric width.

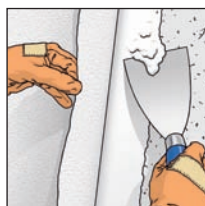

- 10.** Paint over ERFURT-FlexoMur® twice using weather-resistant latex paint. In the event of large cracks of group B + C, paint over with elastic paints.

Product description

Manufacturer

Erfurt & Sohn KG
Hugo-Erfurt-Straße 1
D-42399 Wuppertal
www.erfurt.com

Product group

ERFURT-Facade System

Product designation

ERFURT-FlexoCol®

Raw materials/manufacturing

ERFURT-FlexoCol® is a reinforcement adhesive, especially developed for ERFURT-FlexoMur®, on the basis of the binding agent acrylate copolymer, with high adhesion.

The container size of ERFURT-FlexoCol® is 20 kg per tub.

Characteristics

- White pigmented
- Density: approx. 1.20 kg/dm³
- Capable of rolling, thixotrope set, stir when using
- Dilution with water is possible
- Withstands cement and bridges cracks
- In combination with mineral base surfaces in the system structure with ERFURT-FlexoMur® highly flame retardant as per DIN 4102-B 1
- Without added heavy metal compounds and formaldehyde
- Water vapour permeability as per DIN 52615 corresponds to a diffusion-equivalent air layer density of 0.41 m in the system structure with ERFURT-FlexoCol®, ERFURT-FlexoMur® and a highly-elastic facade coating.

Application/processing

Use ERFURT-FlexoCol® for sticking ERFURT-FlexoMur®. ERFURT-FlexoCol® can be applied to all good-bearing, firm, clean, dry and even base surfaces, such as all forms of plaster and brickwork, concrete or porous concrete surfaces.

ERFURT-FlexoCol® can be used for renovating heat insulation compound systems (WDVS) in the system with ERFURT-FlexoMur®.

ERFURT-FlexoCol® can be used on surfaces already coated with mineral or latex paint, whereby the instructions of the respective required base surface pre-treatment must be observed.

Base surface

The base surface must be dry, clean, firm and smooth. Remove any non-adhering old paint. Pre-coat the base surface with solvent-containing, penetrating stopper. If necessary, open up cracks and reinforce expertly. To create even surfaces, use weather-resistant filler such as Ardex Arduplast F3 or PUFAS Pufaplast V 30. To create optically perfect joins, for example on outside corners, intrados, bases etc., pre-stick end profiles from the heat insulation compound systems, available from

the specialist trade, and subsequently smooth over with a spatula. If the cracks run near the strip seam, pre-stick these with strips of reinforcement fabric e.g. Hosch or Kobau.

Processing conditions

Application of the adhesive with the lambskin roller or a suitable airless device. Consumption 0.8 to 1.3 kg/m² depending on base surface and application amount. To prevent adhesion problems, do not pre-coat too great a surface area. Processing temperature not below + 5° C. The base surface must be free of frost. Avoid exposure to direct sunlight.

Adhesion

To stick, apply ERFURT-FlexoCol® reinforcement adhesive evenly and generously over the entire surface, using the lambskin roller. Cut ERFURT-FlexoMur® with additive to size, roll up and lay in the adhesive with butt joint. Press against using the rubber roller and/or a synthetic spatula. Do not stick ERFURT-FlexoMur® overlapping, if necessary make double-stitch cut. Seal joints with acrylic. Excess adhesive must be washed off immediately and thoroughly.

Drying

Drying depends on the temperature and humidity, as well as on the absorbency of the base surface. At 20° C and 50% humidity, the drying time for ERFURT-FlexoCol® in the system with ERFURT-FlexoMur® is one day.

Tool cleaning

Immediately after use with water.

Storage

Store ERFURT-FlexoCol® containers tightly sealed, cool and free of frost. Protect against direct sunlight; possibly cover half-used containers with a little water. Can be stored for at least one year in sealed, original container.

Disposal

Dried-up or set remains of ERFURT-FlexoCol® can be disposed of with the normal domestic refuse. Material that has not set should be mixed with cement and allowed to harden before being disposed of.

Ingredients/test results

Water vapour permeability as per DIN 52615, corresponds to a diffusion-equivalent air layer density of 0.41 m in the system structure with ERFURT-FlexoCol®, ERFURT-FlexoMur® and a highly-elastic facade coating.

Product description

Manufacturer

Erfurt & Sohn KG
Hugo-Erfurt-Straße 1
D-42399 Wuppertal
www.erfurt.com

Product group

ERFURT-Facade System

Product designation

ERFURT-FlexoMur®

Raw materials/manufacturing

ERFURT-FlexoMur® is a structured wall covering for adhesion on facades and outside surfaces, manufactured as a 2-component, compound system from special synthetic fibres. The weight of ERFURT-FlexoMur® is 170 g/m², roll dimensions 25.00 m long x 0.71 m wide.

Two rolls are packed together in a carton.

Characteristics

- Highly elastic and dimensionally stable
- Crack-bridging, non-sensitive to knocks, alkali-resistant
- Structured for outer surfaces
- Edged and foil-packed
- In combination with ERFURT-FlexoCol® effectively covers over colour contrasts of the base surface
- In a compound with mineral base surfaces, highly flame retardant as per DIN 4102-B 1
- Free from PVC, softeners, solvents and glass fibres
- Without added heavy metal compounds and formaldehyde
- Weather-resistant, capable of diffusion and capable of being painted over with all, especially elastic, facade paints
- Highly hard-wearing in the system with ERFURT-FlexoCol® reinforcement adhesive and corresponding coating substance
- Water vapour permeability as per DIN 52615 corresponds to a diffusion-equivalent air layer density of 0.41 m in the system structure with ERFURT-FlexoCol®, ERFURT-FlexoMur® and a highly-elastic facade coating.

Application/processing

With ERFURT-FlexoMur®, outer surfaces are redeveloped rationally and designed with a plaster optic in one single work step. ERFURT-FlexoMur® can be stuck on all good-bearing base surfaces. A particular area of use is on old, cracked, smooth plaster, which, following corresponding pre-treatment of the base surface, is stuck and subsequently painted over. It also serves the creation of even-structured, paintable wall surfaces, for example on mixed base surfaces, on smoothed areas and reworked cracks.

ERFURT-FlexoMur® is the ideal coating base for all base surfaces that are otherwise stuck with reinforcement coverings and subsequently reworked with decorative plaster, or for fabric reinforcement that is only painted over.

Base surface

The base surface must be dry, clean, firm and smooth. Remove non-adhering old paint. Pre-coat the base surface with solvent-containing, penetrating stopper. If necessary, open up cracks and reinforce professionally. To create even surfaces, use weather-resistant filler, such as Ardex Arduplast F3 or PUFAS Pufaplast V 30. To produce optically perfect joints, for example on outer corners, intrados, bases etc., pre-stick end profiles from the heat insulation compound systems, available from the specialist trade, and subsequently smooth over. If there are cracks in the area of the strip seam, pre-stick these with strips of reinforcement fabric such as Hosch or Kobau

Adhesive

Use ERFURT-FlexoCol® from the ERFURT-Facade System. Apply the adhesive with the lambskin roller or a suitable hairless device. Consumption 0.8 to 1.3 kg/m² depending on base surface and application amount. To avoid adhesion problems, do not pre-coat too large a surface. Processing temperature not below + 5° C. Avoid exposure to direct sunlight.

Adhesion

To stick, apply ERFURT-FlexoCol® reinforcement adhesive evenly, using the lambskin roller. Cut ERFURT-FlexoMur® with additive to size, roll up and lay in the adhesive with butt joint. Press against using a rubber roller and/or a straight edge. Press protruding material on all connection points, such as windows, doors bases etc., into the corner with a straight edge and trim with a knife.

Do not apply ERFURT-FlexoMur® overlapping, if necessary make double-stitch cut. Seal joints with acrylic. Excess adhesive must be washed off immediately and thoroughly. Do not stick inclined or change the direction. ERFURT-FlexoMur® can be struck both longways and crossways.

Painting

As a rule, ERFURT-FlexoMur® can be reworked after drying over night. Given high humidity and/or low temperatures, longer drying periods must be taken into account.

Following drying, paint over ERFURT-FlexoMur® twice with suitable, weather-resistant latex paint:

- Crack category A with classic facade paints
- Crack category B with classic facade paints or elastic systems, depending on size of the cracks
- Crack category C with elastic systems.

Thanks to the weather-resistance of ERFURT-FlexoMur® a difference of several weeks (max. 8) between drying of the wall covering and the first coat of paint poses no problems.

Ingredients/test results

Water vapour permeability as per DIN 52615 corresponds to a diffusion-equivalent air layer density of 0.41 m in the system structure with ERFURT-FlexoCol®, ERFURT-FlexoMur® and a highly-elastic facade coating.